

## 固化燈使用說明

# LUNA CURE

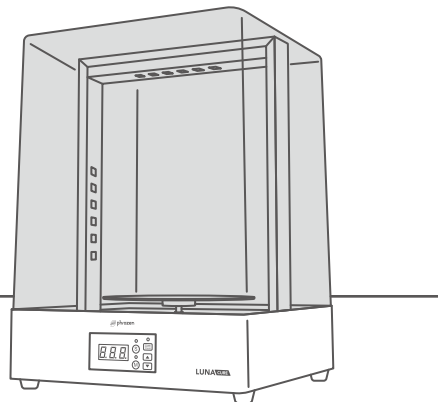

### 01 啟動電源及開關

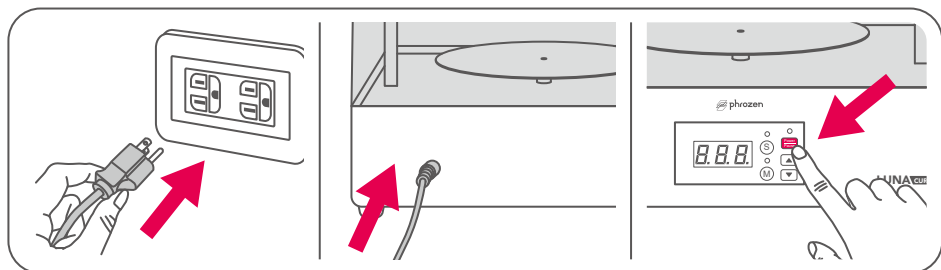

#### 開啟機台電源

接上電源線，按下 [Power] 按鈕。

#### 關閉機台電源

長按 [Power] 按鈕，聽到嗶聲後，固化燈電源即關閉。

### 02 設定固化時間

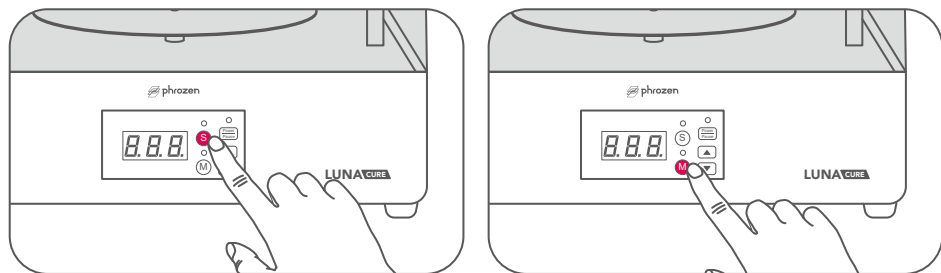

#### 按鍵 (S) 為預設模式

此模式可快速選擇三種預設固化時間，分別為5分鐘、10分鐘及20分鐘。

#### 按鍵 (M) 為手動模式

按下按鍵M後，點擊上下鍵每次可增減1分鐘。長按上下鍵，則可快速增減分鐘數。

### 03 固化燈運轉

蓋上遮光罩，按下 [Power] 按鈕，固化燈即開始運轉。

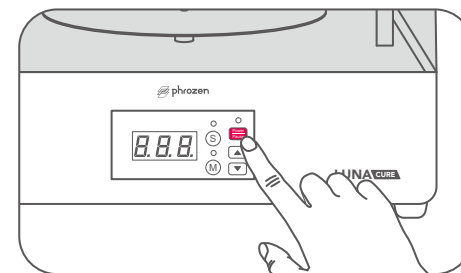
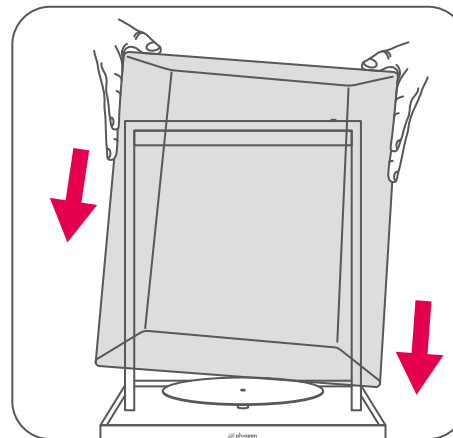

## 注意 事項

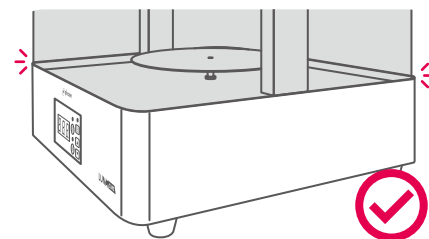

固化燈蓋上後需確實與底座的四個邊吻合，才能啟動固化燈運轉。

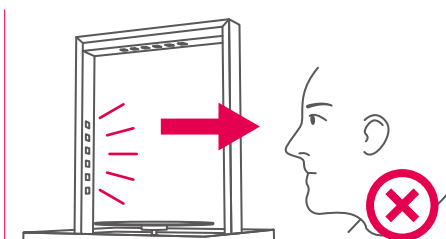

請勿在未蓋上遮光罩的情況下直視固化燈光源，此動作可能造成眼部損傷。

8歲以上兒童、肢體及行為障礙者需在法定監護人的指導下使用本產品，以確保使用者知悉所涉及的風險。禁止兒童在沒有監護人的陪同下使用本產品。

未經法定監護人陪同，禁止兒童清潔或維護本產品。

**保養方式** 如需外觀清潔請用酒精擦拭，請勿用油性或腐蝕性的液體擦拭。



Facebook



Facebook  
台灣站社團



YouTube



Instagram



## UV Curing Lamp User Guide

# LUNA CURE

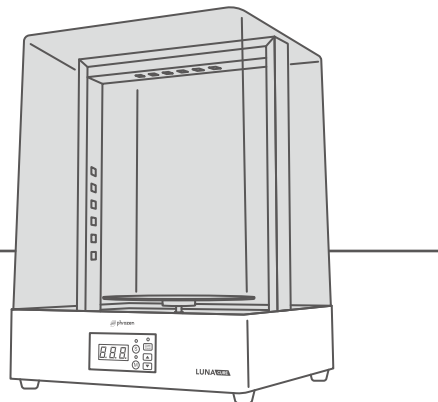

### 01 Power Supply & Light Switch

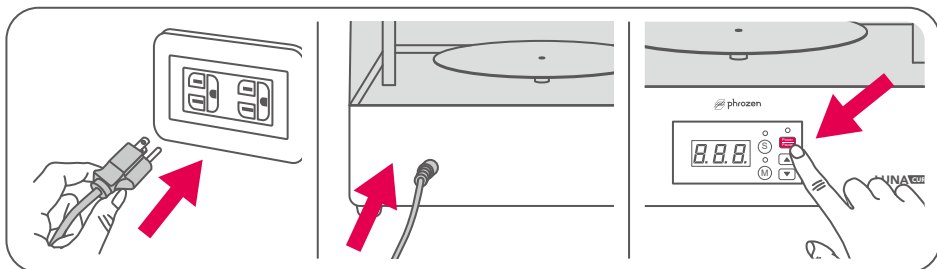

#### Turn on the device

Connect the power cable. Press the Power button to turn on the device.

#### Turn off the device

Long press the Power button. The curing lamp will turn off after a beep sound.

### 02 To Set Curing Time

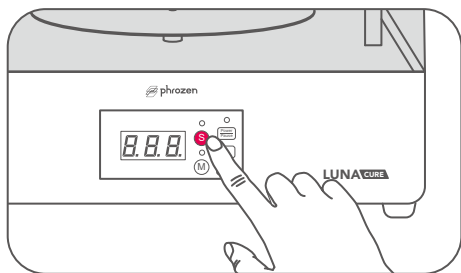

#### Click the button (S) for preset modes

This comes with three curing time settings: 5 min, 10 min, 20 min.

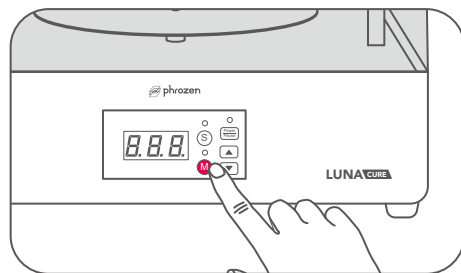

#### Click the button (M) for custom mode

Click on the up and down keys to increase or decrease 1 minute each time. Long press the keys to quickly increase or decrease the minutes.

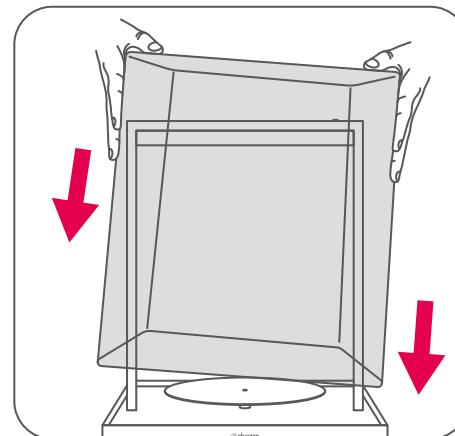

### 03 How to Operate the UV Curing Lamp

Close the UV lamp cover. Click on the Power button. The curing lamp will begin operation.

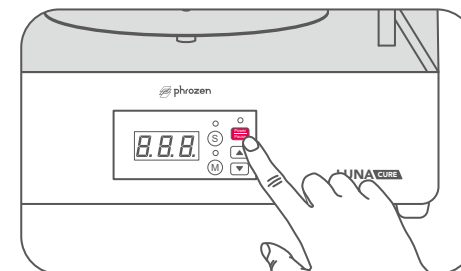

### Warning

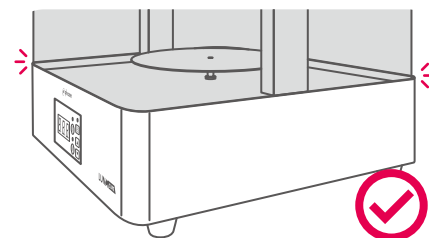

The UV lamp cover needs to fit all four sides of the base perfectly for the device to begin operating.

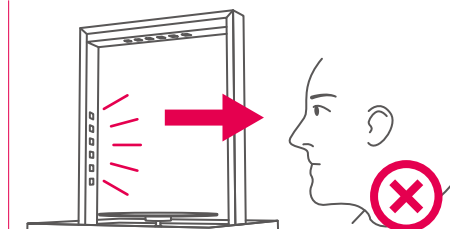

Do not stare at the UV curing lights without closing the UV lamp cover, this may cause damage to your eyes.

This appliance can be used by children aged 8 and above as well as by persons with reduced physical, sensory, or mental capabilities, if supervised or given instruction regarding the use of the appliance in a safe way, to ensure that the hazards involved are understood. Children are NOT allowed to play with the appliance.

Children are NOT allowed to clean or provide maintenance without adult supervision.

#### Standard Maintenance Procedure

Please use sanitizing alcohol to clean the outside of your device. Do not use any oily or corrosive liquids or to clean the device.



Facebook



Facebook Group



YouTube



Instagram